



### LOCATION MAP



### Key distances

Tata Motors	: 05 min
Pune Airport	: 25 min
Hinjewadi IT Park	: 30 min
ICC Center (Moshi)	: 07 min
KSB Chowk	: 05 min
Pune-Mumbai Bypass	: 15 min
Talawade IT Park	: 03 min
Chakan MIDC	: 10 min

### Creadits

**ARCHITECTS**  
Hrishikesh Deore

**R.C.C.**  
Ravindra Karnavat

**LEGAL**  
Adv. Nilesh B Kamthe

### SITE ADDRESS

CTS No. 345, Dehu - Alandi Road  
Near Bus stop, Chikhali,  
Pune - 411 062

For Booking Contact : +91 9822 555 424 | +91 9657 288 768 | +91 9850 854 746



Web: [www.shrisamarthgroup.com](http://www.shrisamarthgroup.com)

### PROJECT BY

**ROHAN ASSOCIATES**  
Developers, Promoters & Builders

OFFICE ADDRESS: Gat No. 198, Opp. Priyadarshani School, Shri Samarth Nagar, Dehu-Alandi Road, Borhadewadi, Moshi, Tal. Haveli, Dist. Pune - 412 105.  
Call.: +91 800 701 8080 | +91 800 710 8080. E-mail: [info@shrisamarthgroup.com](mailto:info@shrisamarthgroup.com) | [sachin@shrisamarthgroup.com](mailto:sachin@shrisamarthgroup.com) | [sachinkhupse41@gmail.com](mailto:sachinkhupse41@gmail.com)

The content of this brochure are purely conceptual and have no legal binding on us. Developers reserve the rights to amend the layout plans, number of flats, elevation, colour scheme, specification and amenities

*Dreams Don't work, Unless you do...*







- **WALLS**  
External wall of 6" thick brick work, single coat of sand face plaster. Internal partition walls to be 4" brick work with Niru finished plaster.
- **FLOORING**  
2X2 Vitrified flooring, W.C. Bath Anti-Skid Ceramic Tile
- **DOOR**  
Attractive Main Door with Decorative Door Skin Internal Flush Door with Oil Paint Finish
- **KITCHEN**  
Granite kitchen top platform with S. S. sink Designer wall files up to lintel level



- **WINDOW**  
3 track powder-coated aluminum sliding windows Marble Sill for all windows
- **PLUMBING**  
Concealed plumbing work with Standard bathroom fittings Standard make Sanitary Fittings
- **BATHROOM & W.C.**  
Glazed tiles in W.C., bath up to lintel level with modern concepts.
- **PARKING AREA**  
Paving blocks / Checkered tiles in attractive pattern. Ample parking.

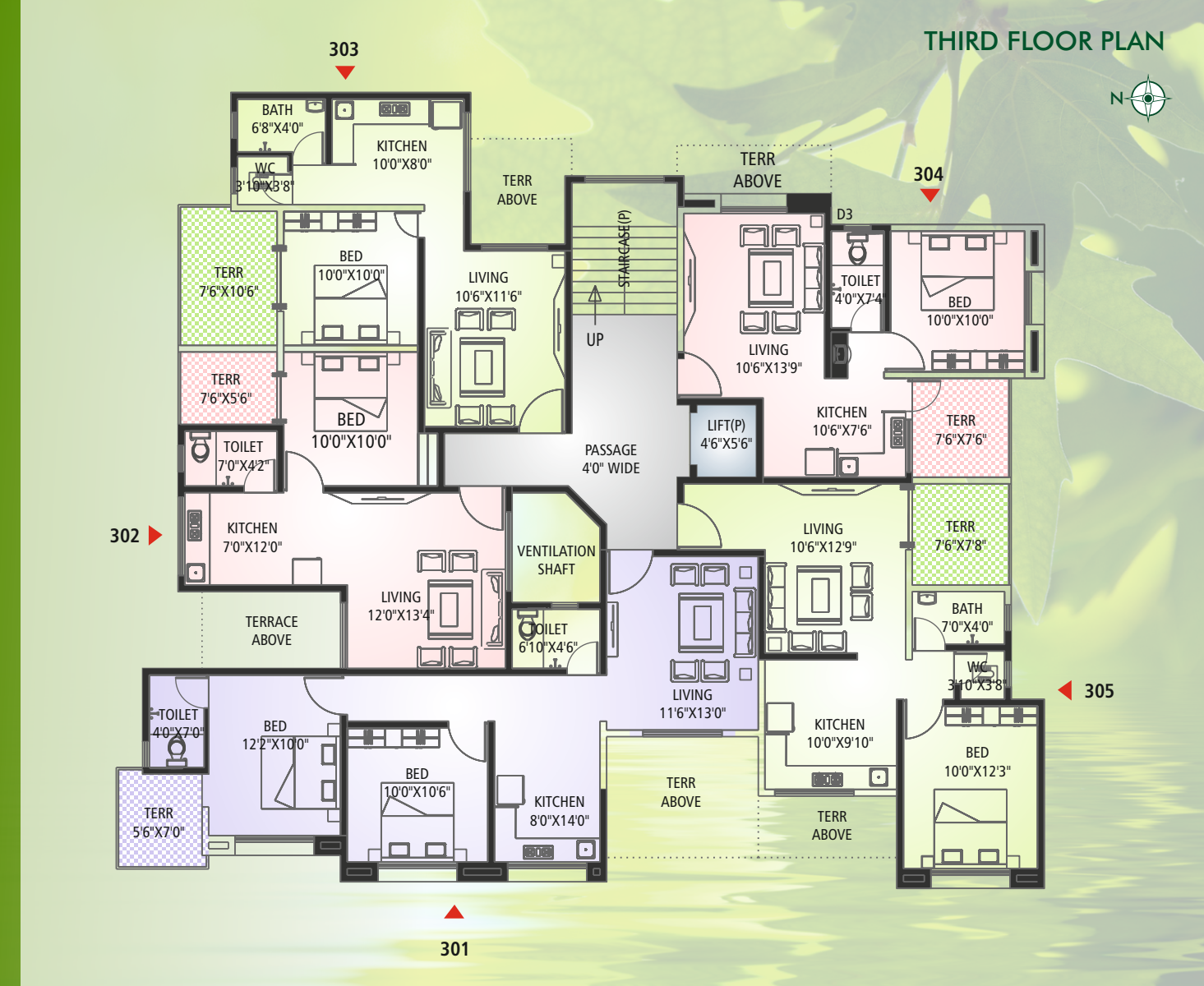

- **PAINTING**  
Water Proof Acrylic paint for the external face of the building. Oil bond distemper for the internal face of the apartment.
- **ELECTRIFICATION**  
Concealed copper wiring with modular switches TV & telephone points in living room and master bedroom Adequate light points in each room Ample light point in parking